

#

Ghost Ring EX Accessory Rail Instructions

Assembly

The side accessory rail easily mounts to the Ghost Ring Front Sight and offers an excellent way to mount a flashlight or laser sight. Remove the 3/4" bolt that came with the Front Sight and replace it with the longer 1 1/8" bolt for the side rail.

The rail can be mounted on either side of the Front Sight.

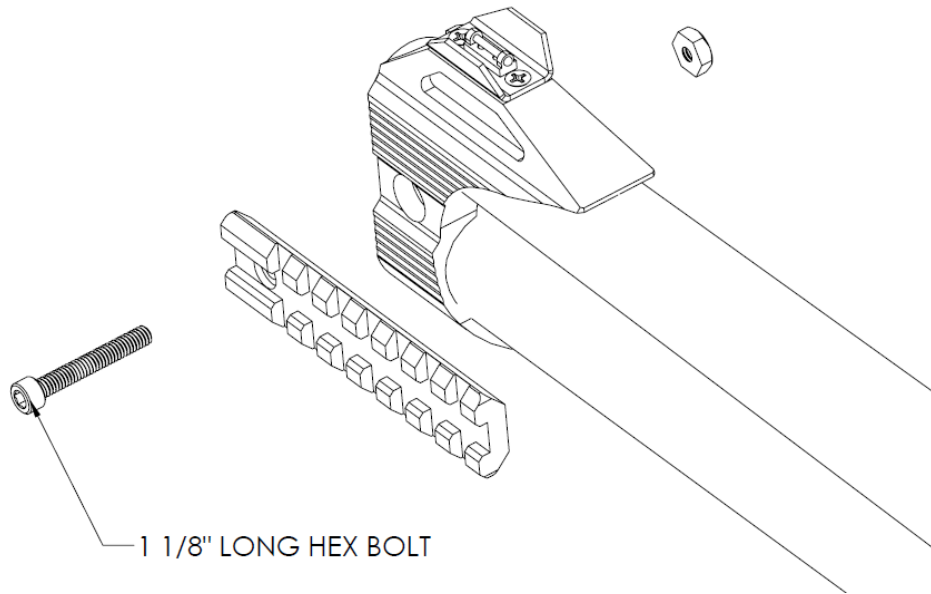

The rail fits on both versions of the Front Sight (with or without magazine extension tube) and locks in place with a unique taper fit. **It is strongly recommended to not mount anything that extends past the shotgun barrel.**

